



287 Tiyces Lane Boxers Creek NSW

4 2 3

- Well positioned just 25km to the heart of Goulburn, 115km to the centre of Canberra and 230km to Sydney CBD, 'Chivari Lodge' is the perfect weekend tree-change escape for those seeking a rural lifestyle change with a difference.

- Positioned on a cleared parcel of just over 10 hectares, the property is created with the horse lover in mind, or those seeking a small holding on which to raise animals.

- Modern and understated, the homestead has three bedrooms and an open plan living area that captures expansive views across the countryside. There is a modern Caesarstone kitchen with electric appliances and breakfast bar.

Type : House

View : <https://www.ciresydney.com.au/sale/nsw/capital-monaro-snowy/boxers-creek/residential/house/8055223>



James Hall
02 9328 1422



Darren Curtis
02 9328 1422

[For full version visit the website](https://www.ciresydney.com.au)

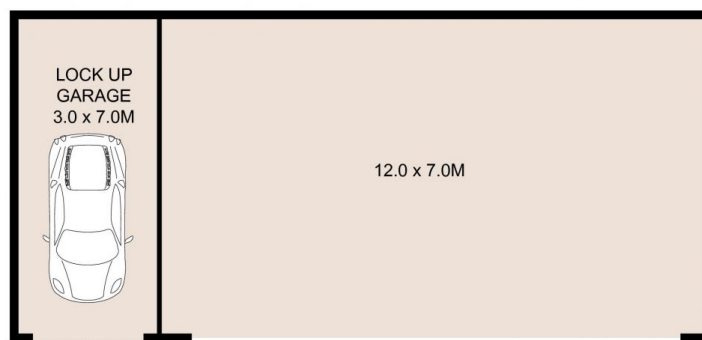
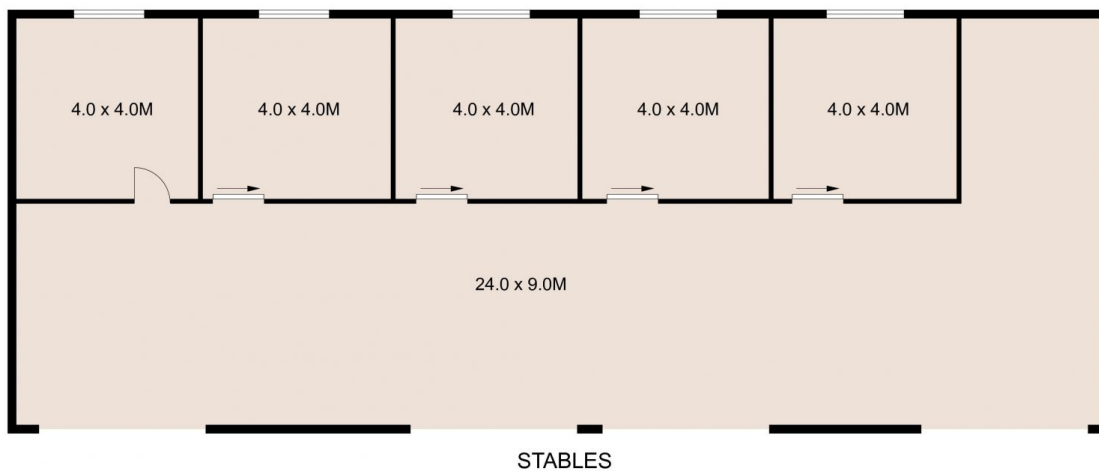
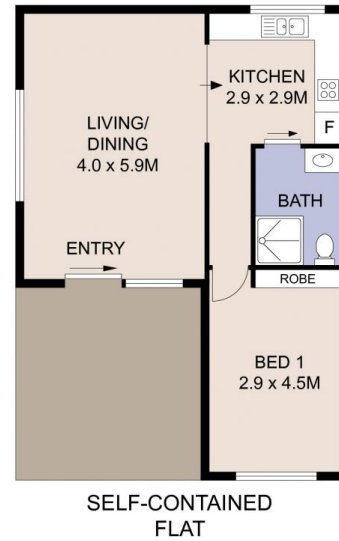

TOTAL INTERNAL: 479 m²
TOTAL LAND SIZE: 101171 m²



287 TIYCES LANE

BOXERS CREEK

Plans shown are for presentation purposes only and are not part of any legal document or title. They are subject to errors, omissions, inaccuracies and should not be used as a sole and accurate reference. Interested parties should make their own inquiries using independent sources.

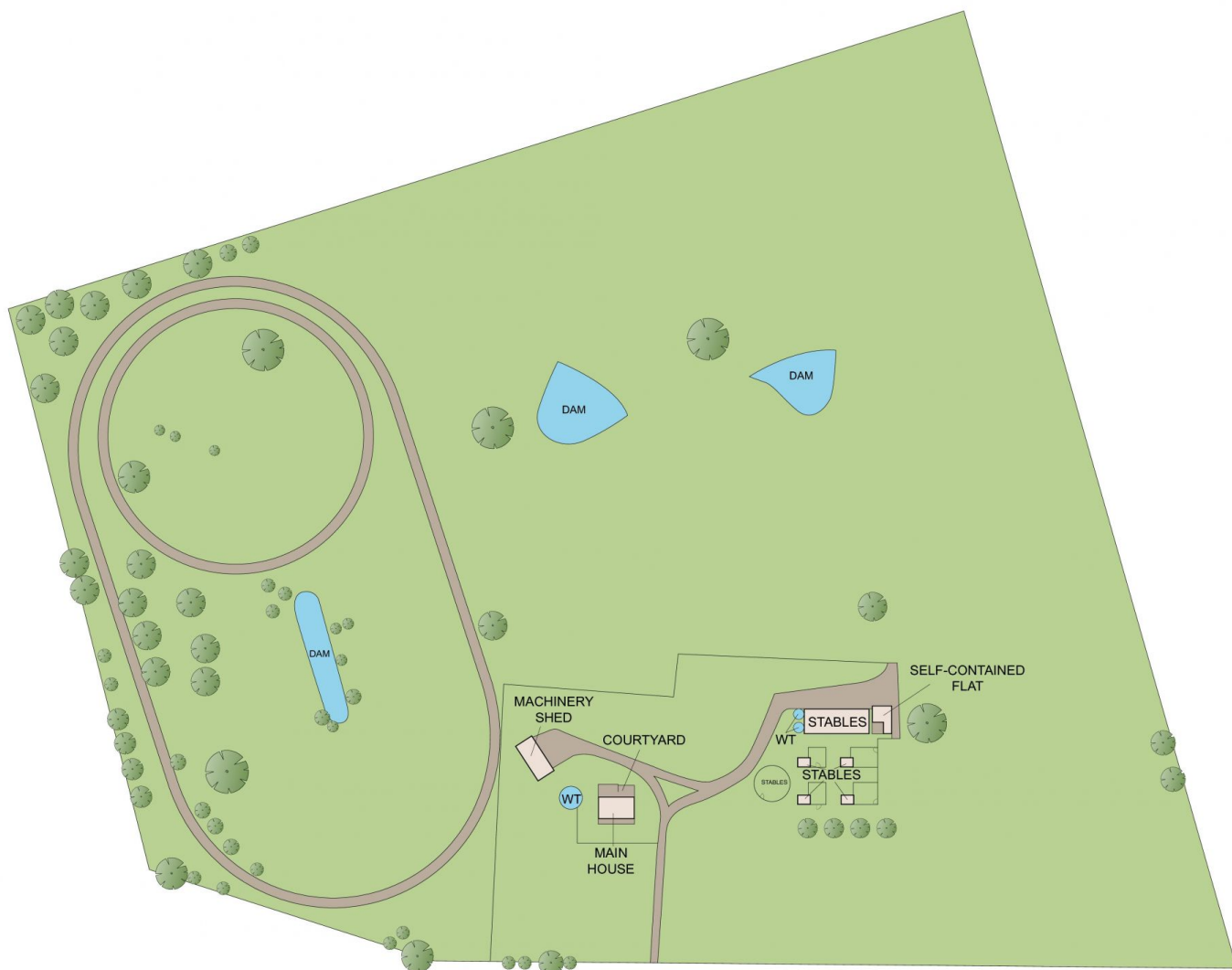

SITE PLAN (NOT TO SCALE)



TOTAL INTERNAL: 479 m²
TOTAL LAND SIZE: 101171 m²



Plans shown are for presentation purposes only and are not part of any legal document or title. They are subject to errors, omissions, inaccuracies and should not be used as a sole and accurate reference. Interested parties should make their own inquiries using independent sources.

287 TIYCES LANE

BOXERS CREEK