



**461 Range Road Mittagong NSW**

5 🏠 4 🚗 3 🚘

- Dominated by 180-degree panoramic views that stretch uninterrupted northwards across the countryside to the city skyline and westward to the distant haze of the Blue Mountains, the exceptional 'Glen Lorne' is an estate worthy of only the most discerning.

- Brand-new and finished to the most exacting of standards with sublime customised features and an unerring attention to detail throughout, the home floats above the landscape with sleek lines and an overwhelming understanding of the built environment within the natural setting.

- Architecturally crafted by the esteemed Tina Tziallas, the home enjoys a seamless interplay of light and flowing space, with the indoors and outdoors seamlessly entwined

**Type** : House

**View** : <https://www.ciresydney.com.au/sale/nsw/southern-highlands/mittagong/residential/house/8055230>



**James Hall**  
02 9328 1422



**Darren Curtis**  
02 9328 1422

[For full version visit the website](https://www.ciresydney.com.au)



FIRST FLOOR



GROUND FLOOR

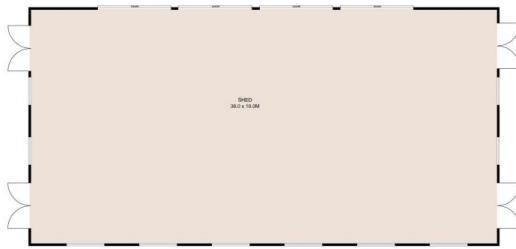

0 2 4 6 8 10 12 14 16 18 20 22 24 26 28 30 32 34 36 38 40 42 44 46 48 50 52 54 56 58 60 62 64 66 68 70 72 74 76 78 80 82 84 86 88 90 92 94 96 98 100

Plans shown are for presentation purposes only and are not part of any legal document or title. They are subject to errors, omissions, inaccuracies and should not be used as a sole and accurate reference. Interested parties should make their own inquiries using independent sources.

GLEN LORNE, 461 RANGE ROAD

MITTAGONG

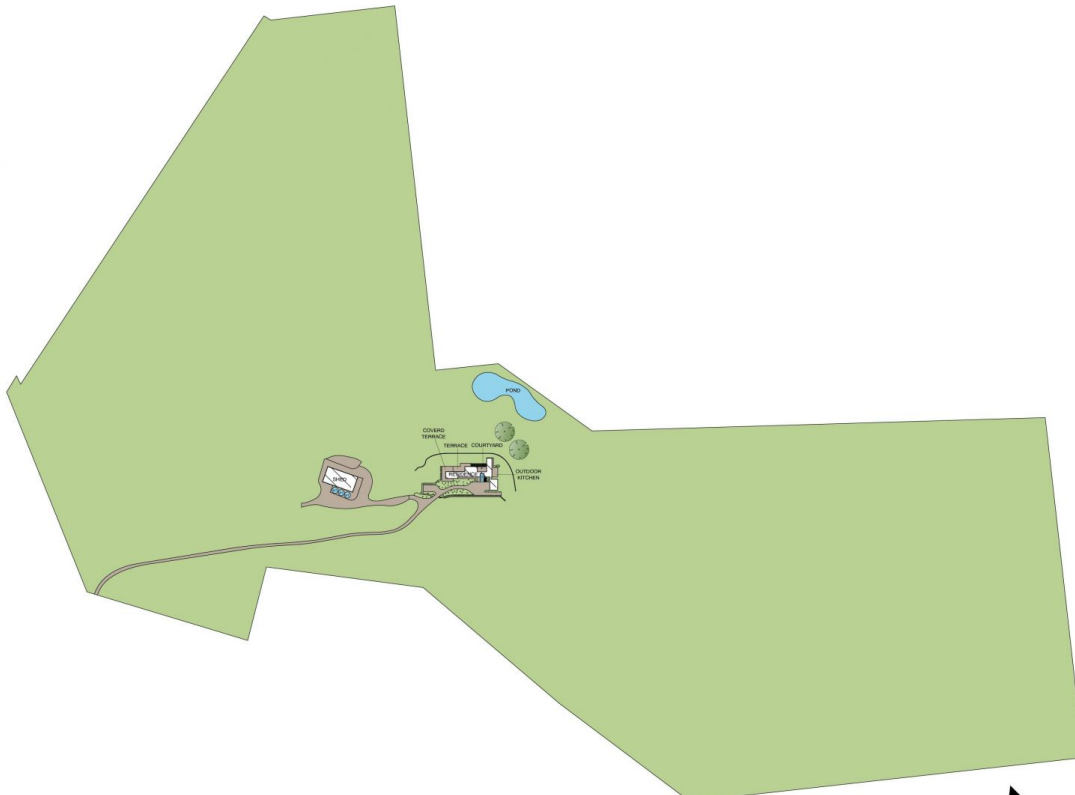

0 2 4 6 8 10 12 14 16 18 20 22 24 26 28 30 32 34 36 38 40 42 44 46 48 50 52 54 56 58 60 62 64 66 68 70 72 74 76 78 80 82 84 86 88 90 92 94 96 98 100

Plans shown are for presentation purposes only and are not part of any legal document or title. They are subject to errors, omissions, inaccuracies and should not be used as a sole and accurate reference. Interested parties should make their own inquiries using independent sources.

GLEN LORNE, 461 RANGE ROAD

MITTAGONG