



POINT PIPER

7 🏠 6 🚗 6 🚗

Secure a piece of paradise and become a part of this privileged harbourfront enclave in one of Sydney's most prestige addresses. Gazing north east over Felix Bay's boat filled waters with views to Shark Island and across to Manly; this gracious 1890s residence represents a once-in-a-lifetime opportunity to acquire a magnificent harbour property of unlimited future promise.

Type : House
Land Size : 998.8 sqm
View : <https://www.ciresydney.com.au/sale/nsw/ea-stern-suburbs/point-piper/residential/house/8055339>

One of the last remaining original homes in this highly prized suburb

Held within the same family for nearly 70 years

A level 1,000sqm (approx.) street-to-waterfront landholding, north facing

Just under 12m beach frontage and direct private access to Lady Martin Beach

[For full version visit the website](#)



Darren Curtis
02 9328 1422



LOWER LEVEL

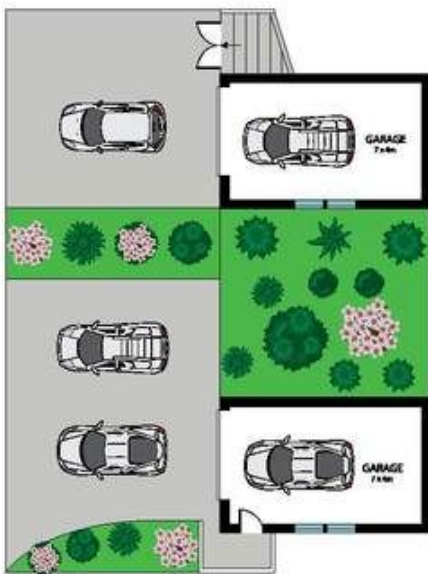

ENTRY LEVEL



LEVEL ONE

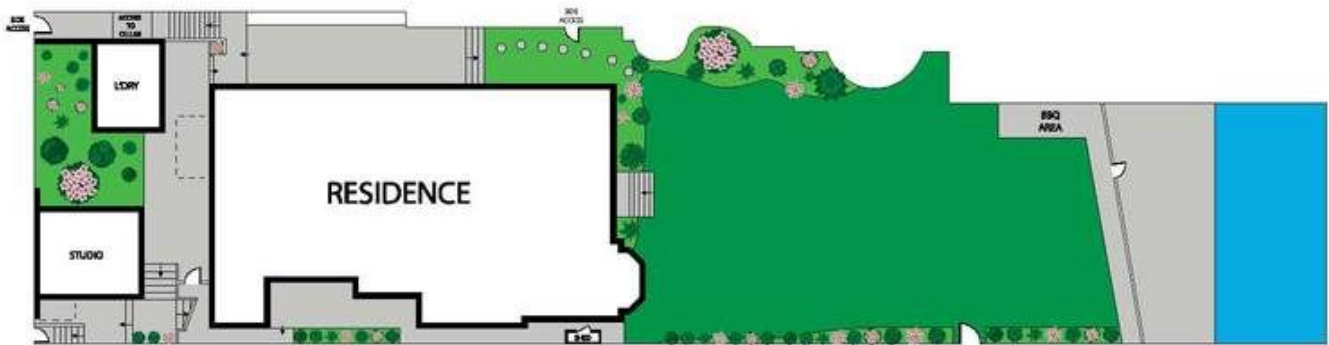

SITE PLAN (NOT TO SCALE)

