



**29 Herbert Street Leura NSW**

5 🛏 3 🚿 2 🚗

'Roseneath' is a luxuriously designed and master built weatherboard residence completed in 2017 occupying a substantial corner block of approx. 1,448sqm less than 2.0km from the heart of Leura village. Embraced by sweeping level lawns and gardens featuring a desirable north to rear aspect, the home is exceptionally private and displays superior craftsmanship with sophisticated contemporary finishes yet radiates the romantic charm and elegance of a bygone era. The result is a home of timeless architectural beauty and effortless functionality that's both aesthetically pleasing and a joy to live in.

Interiors brimming with light and character display thoughtful attention to even the smallest detail, with open living spaces, generous accommodation and easy

[For full version visit the website](#)

**Type** : House  
**Price** : Expressions of Interest  
**View** : <https://www.ciresydney.com.au/sale/nsw/blue-mountains-surrounds/leura/residential/house/8166892>



**Erik Stoneberg**  
02 9328 1422



FIRST FLOOR



GROUND FLOOR

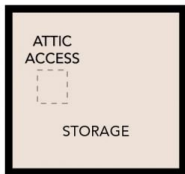

ATTIC

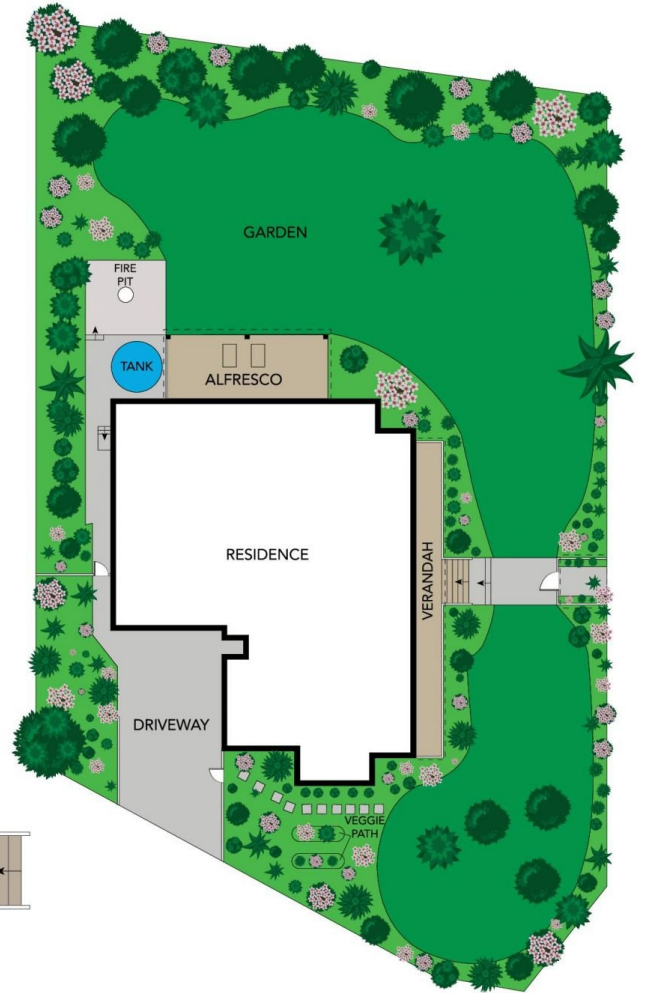

SITE PLAN



LAND: 1,448m<sup>2</sup>



Plans shown are for presentation purposes only and are not part of any legal document or title. They are subject to errors, omissions, inaccuracies and should not be used as a sole and accurate reference. Interested parties should make their own inquiries using independent sources.

29 Herbert Street, Leura